

ADDENDUM No. 4 – June 19th 2025

1-page total

PROJECT: PEDESTRIAN PLAZA
BID # CB-2543
Abilene, Texas

BID DATE: Tuesday, June 24th, 2025 – 10:00AM

FROM: *la terra studio, LLC*
Michael Black, RLA
214.749.0333
12001 North Central Expressway, Suite 1170
Dallas, Texas 75243



TO: Plan Holders / Prospective Bidders

This Addendum **No.4** forms a part of the Contract Documents and modifies the original Bidding Documents dated **May 30th, 2025** as noted below. Acknowledge receipt of this Addendum must be included with a bid submission. Failure to do so may subject the Bidder to disqualification.

CHANGES TO BIDDING REQUIREMENTS

1. None

CHANGES TO DRAWINGS AND SPECIFICATIONS

1. Revised Sheet C1.0 – Remove replacement of drive approach from project.
2. Revised Sheet C2.0 – Remove replacement of drive approach from project.
3. Revised Sheet C3.0 – Remove replacement of drive approach from project, Remove and abandon existing water meter.
4. Revised Sheet L0.10 – Remove replacement of drive approach from project.
5. Revised Sheet L1.00 – Remove replacement of drive approach from project.

CLARIFICATIONS:

1. None

ATTACHMENTS:

1. Revised Plan Sheet C1.0 – Dimensional Control Site Plan
2. Revised Plan Sheet C2.0 – Grading Plan
3. Revised Plan Sheet C3.0 – Utility Plan
4. Revised Plan Sheet L0.10 – Overall Site Plan
5. Revised Plan Sheet L1.00 – Site Plan

End Addendum No. 4

X:\CL\La Terra Studio\24507 - Cypress Pedestrian Plaza - La Terra Studio\Drafting\Plans\1_C_01\01_DIMENSIONAL CONTROL SITE PLAN.dwg Saved By: amedina Save Time: 6/19/2025 8:27 AM Plotted by: santolaga medina Plot Date: 6/19/2025 8:30 AM

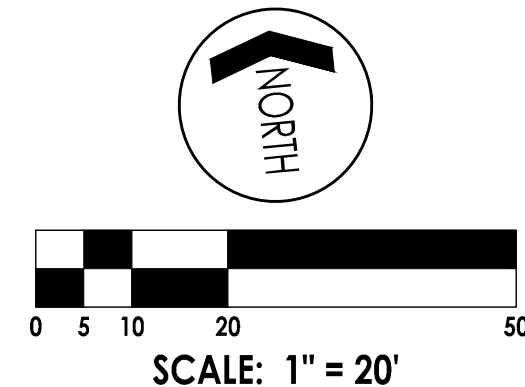
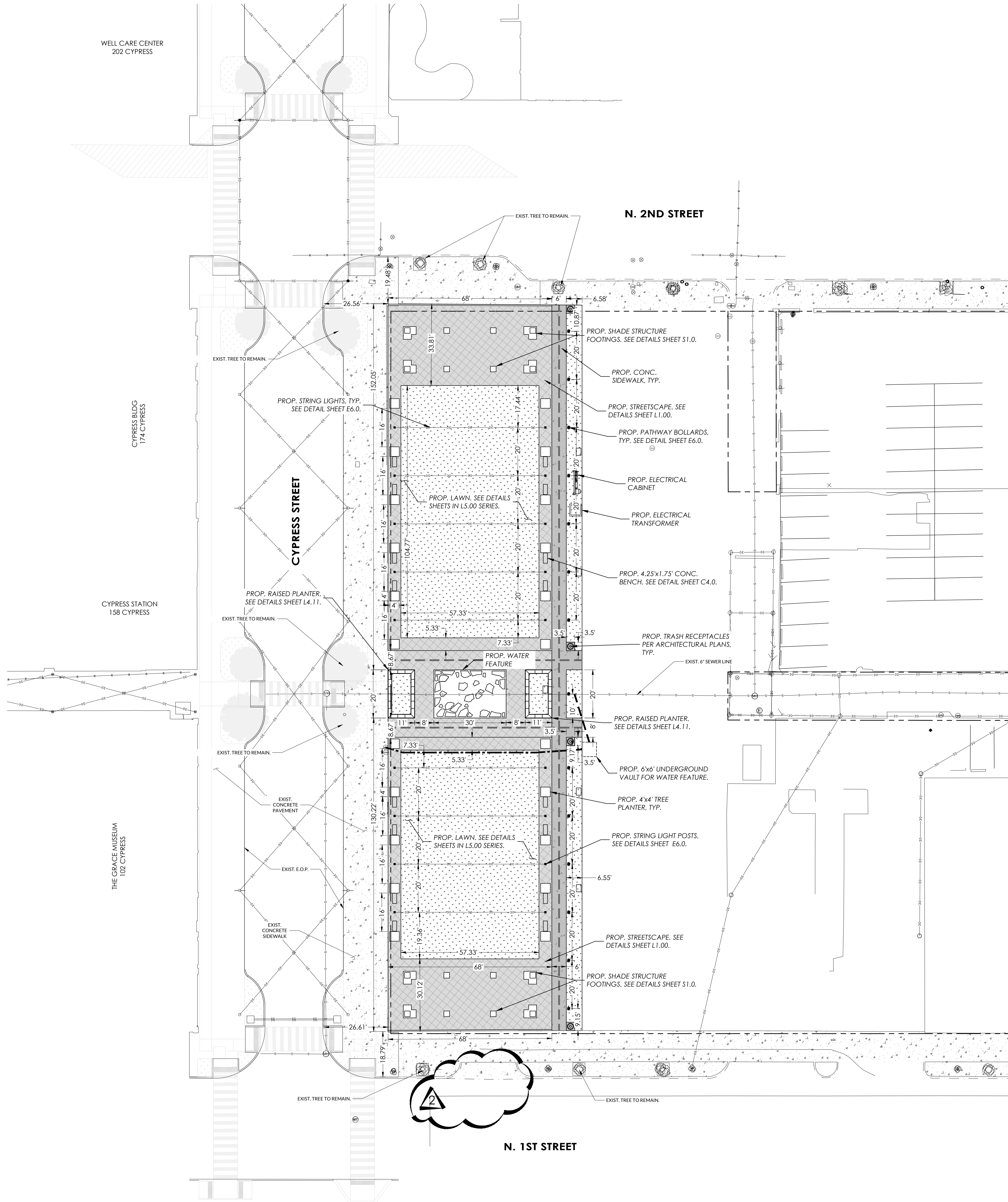

- SITE PLAN NOTES:**
1. PROPERTY OWNER: CITY OF ABILENE
 2. ALL KNOWN EASEMENTS ARE SHOWN ON THIS TRACT.
 3. OVERALL HEIGHT OF SHADE STRUCTURES IS 21'.
 4. ALL SURFACES ON THIS SITE WILL BE PROPOSED. ALL AREAS NOT COVERED BY BUILDING FOOTPRINTS OR PAVING WILL BE GRASS OR VEGETATIVE COVER.
 5. ONE EXISTING DRIVEWAY WILL BE CLOSED.
 6. PROPOSED SIDEWALKS ON THIS SITE ARE ACCESSIBLE.
 7. ACCESSIBLE ROUTES INCLUDE ALL ACCESSIBLE SIDEWALKS AS WELL AS THE PROPOSED SIDEWALK RAMPS AND PEDESTRIAN CROSSINGS AT THESE RAMPS.
 8. ALL OUTDOOR LIGHTING SHALL MEET CITY OF ABILENE REQUIREMENTS AND ALL OUTDOOR LIGHTING FIXTURES SHALL BE FULLY SHIELDED.
 9. INTERNET, TELEPHONE AND CABLE PROVIDERS AS WELL AS IRRIGATION CONTRACTORS SHALL COORDINATE INSTALLATION OF NECESSARY CONDUIT PRIOR TO PLACEMENT OF PAVING.

- DIMENSIONAL CONTROL NOTES:**
1. ALL DIMENSIONS SHOWN ARE FROM FACE OF CURB, BEGINNING & END OF CURVE RADII, AND EDGE OF BUILDING FOUNDATION UNLESS OTHERWISE NOTED. WIDTH OF SIDEWALK ADJACENT TO CURB ARE MEASURED FROM BACK OF CURB.
 2. CURBS ARE NOMINAL 6" WIDE. THEREFORE THE BACK OF CURB IS 0.50' FROM FACE OF CURB.
 3. ALL COORDINATES, BEARINGS AND DISTANCES SHOWN HEREON ARE REFERENCED TO THE TEXAS STATE PLANE COORDINATE SYSTEM, TEXAS NORTH CENTRAL ZONE, NAD83 AND GPS OBSERVATIONS. ELEVATION DATUM IS NAVD88.

DIMENSIONAL CONTROL SITE PLAN L E G E N D			
	SITE BOUNDARY		PROPOSED CONCRETE PAVING
	UTILITY & DRAINAGE EASEMENTS		PROPOSED CONCRETE SIDEWALKS
	PROPOSED WATER LINES		PROPOSED PAVERS
	EXISTING WATER LINES		EXISTING ASPHALT PAVING
	PROPOSED SEWER SERVICE		EXISTING CONCRETE PAVING
	EXISTING SANITARY SEWER MANHOLE		EXISTING GRAVEL PAVING
	EXISTING SEWER LINES		EXISTING CONTOURS
	EXISTING SEWER CLEAN-OUT		
	PROPOSED STRING LIGHTS		
	EXISTING UNDERGROUND ELECTRICAL		
	EXISTING OVERHEAD POWER LINES		
	EXISTING UTILITY POLES		
	EXISTING STREET LIGHTS		
	EXISTING GAS LINES		
	EXIST. UNDERGROUND FIBER OPTIC		
	EXISTING FENCE		
	PROPOSED ACCESSIBLE ROUTE		



la terra studio[™]
landscape architecture
urban design planning

12001 north central expressway, suite 1170
dallas, texas ~ 75243 214.749.0333
www.laterrastudio.com



JACOB MARTIN

TBPE FIRM # 2448 TBAE FIRM # BR 2261 TBPFLS FIRM # 10194493

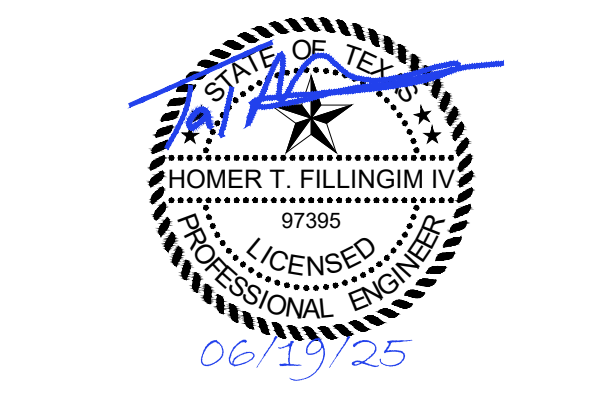

NO.	Date	Issues/Revisions
	5/30/2025	ISSUE FOR BID
2	6/19/2025	ADDENDUM #4

STAMP

NOT FOR CONSTRUCTION- FOR PRICING ONLY

PROJECT NAME

CYPRESS STREET PEDESTRIAN PARK
ABILENE, TEXAS

CONSTRUCTION DOCUMENTATION

PROJECT NO.: 24507
DRAWN BY:
CHECKED BY:

DRAWING TITLE

DIMENSIONAL CONTROL SITE PLAN

DATE: MAY 30, 2025
SCALE: REFER TO PLANS

DRAWING NUMBER

C1.0

Plot Date: 6/19/2025 8:31 AM

Plotted by: santolaga medina

Save Time: 6/19/2025 8:29 AM

Saved By: amadina

X:\CML\La Terra Studio\24507 - Cypress Pedestrian Plaza - La Terra Studio\Drafting\Plans\LA_C_01\LA02 GRADING PLAN.dwg

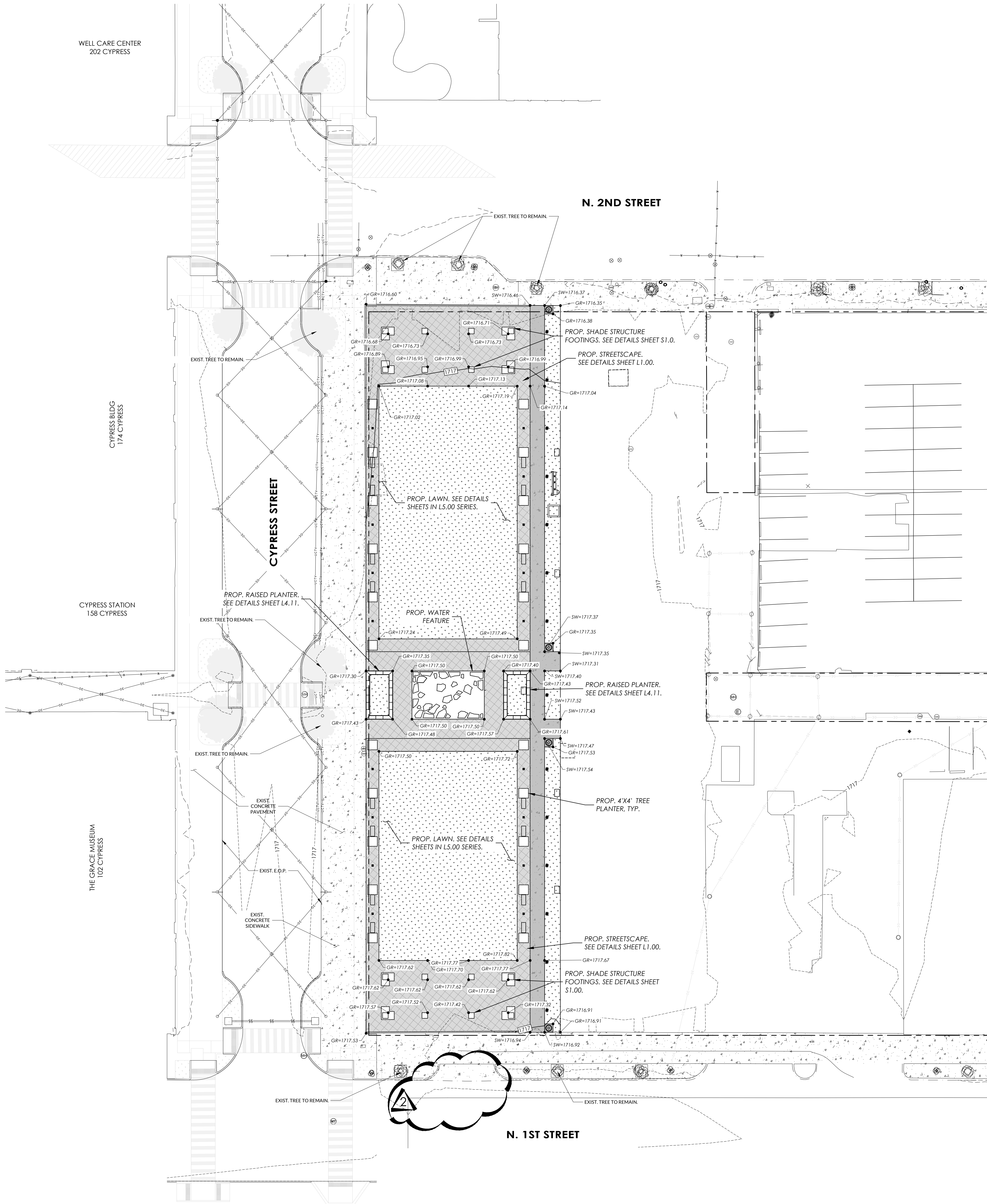

GRADING NOTES:

1. ALL GRADES SHOWN ARE FINAL, TOP OF FINISH SURFACE ELEVATIONS, UNLESS NOTED OTHERWISE.
2. POSITIVE DRAINAGE SHALL BE MAINTAINED ON ALL SURFACE AREAS WITHIN THE SCOPE OF THE PROJECT.
3. CONTRACTOR SHALL TAKE PRECAUTIONS NOT TO ALLOW ANY PONDING OF WATER.
4. NO ABRUPT CHANGES OF GRADE SHALL OCCUR IN THE PAVEMENT AREAS.
5. CONTRACTOR SHALL BE RESPONSIBLE FOR RESTORING TO ITS ORIGINAL, OR BETTER, CONDITION ANY DAMAGES DONE TO EXISTING BUILDINGS, UTILITIES, FENCES, PAVEMENT, CURBS OR DRIVEWAYS.
6. THE CONTRACTOR SHALL BE RESPONSIBLE FOR COORDINATING WITH ALL NECESSARY UTILITY COMPANIES FOR PROVIDING TEMPORARY UTILITY SERVICES DURING CONSTRUCTION.
7. CONTRACTOR WILL MAKE EVERY EFFORT TO LIMIT DISTURBANCE TO AREAS NOT SHOWN ON THE PLANS.
8. CONTRACTOR SHALL IMMEDIATELY NOTIFY THE ENGINEER OF ANY QUESTIONS THAT MAY ARISE CONCERNING THE INTENT, PLACEMENT OR LIMITS OF DIMENSIONS OR GRADES NECESSARY FOR CONSTRUCTION OF THIS PROJECT.
9. CONTRACTOR SHALL BE RESPONSIBLE FOR DISPOSAL OF UNACCEPTABLE/OBJECTONABLE MATERIAL OFF-SITE AT HIS OWN EXPENSE.
10. ALL EXCAVATION ON THIS PROJECT IS UNCLASSIFIED.
11. USE ALL MEANS NECESSARY TO CONTROL DUST ON AND NEAR THE WORK AND ALL OFF-SITE BORROW AREAS, IF SUCH DUST IS CAUSED BY CONTRACTOR'S OPERATIONS DURING PERFORMANCE OF THE WORK OR IF RESULTING FROM THE CONDITION IN WHICH THE CONTRACTOR LEAVES THE SITE. THOROUGHLY MOISTEN ALL SURFACES AS REQUIRED TO PREVENT DUST FROM BEING A NUISANCE TO THE PUBLIC, NEIGHBORS AND CONCURRENT PERFORMANCE OF OTHER WORK ON THE SITE.
12. SIDEWALKS AND ACCESSIBLE ROUTES SHALL HAVE A SLOPE NO GREATER THAN 5% AND A CROSS SLOPE NO GREATER THAN 2% UNLESS NOTED OTHERWISE.
13. GRADING OF ALL HANDICAPPED SPACES AND ROUTES TO CONFORM TO STATE, LOCAL AND FEDERAL GUIDELINES.
14. THE CONTRACTOR SHALL BE REQUIRED TO LOCATE ALL PUBLIC OR PRIVATE UTILITIES INCLUDING BUT NOT LIMITED TO: WATER, SEWER, TELEPHONE AND FIBER OPTIC LINES, SITE LIGHTING ELECTRIC, SECONDARY ELECTRIC, PRIMARY ELECTRICAL DUCTBANKS, LANDSCAPE IRRIGATION FACILITIES AND GAS LINES. ANY UTILITY CONFLICTS THAT ARISE SHOULD BE COMMUNICATED TO THE ENGINEER IMMEDIATELY AND PRIOR TO CONSTRUCTION, THE CONTRACTOR SHALL CONTACT 1-800-DIG-TESS AND THE CITY OF ABILENE UTILITY LOCATE OFFICE AT (325) 676-6425 A MINIMUM OF 48 HOURS PRIOR TO THE START OF CONSTRUCTION. ANY DAMAGE TO EXISTING UTILITIES SHALL BE REPAIRED AT THE CONTRACTOR'S SOLE EXPENSE WHETHER THE UTILITY IS SHOWN ON THESE PLANS OR NOT.

GRADING LEGEND	
	SITE BOUNDARY
	ADJACENT BOUNDARIES
	UTILITY & DRAINAGE EASEMENTS
	EXISTING SANITARY SEWER MANHOLE
	EXISTING SEWER CLEAN-OUT
	PROPOSED STRING LIGHTS
	EXISTING OVERHEAD POWER LINES
	EXISTING UTILITY POLES
	EXISTING STREET LIGHTS
	EXISTING FENCE
	PROPOSED CONCRETE PAVING
	PROPOSED CONCRETE SIDEWALKS
	PROPOSED PAVERS
	EXISTING ASPHALT PAVING
	EXISTING CONCRETE PAVING
	EXISTING GRAVEL PAVING
	PROPOSED CONTOURS
	EXISTING CONTOURS
	PROPOSED DRAINAGE FLOWLINES
	PROPOSED HIGH & LOW POINTS
EXISTING GRADES:	
XEP = EXIST. EDGE OF PAVING	BW = BOTTOM OF WALL
XFL = EXIST. FLOW LINE	GR = PROPOSED GRADE
XGR = EXIST. GRADE	HP = HIGH POINT
XSW = EXIST. SIDEWALK	FF = FINISHED FLOOR ELEV.
	FL = FLOW LINE ELEVATION
	SW = SIDEWALK GRADE
	TW = TOP OF WALL

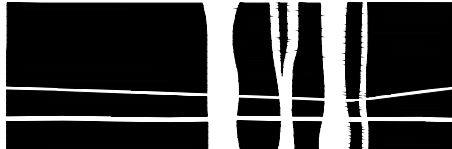
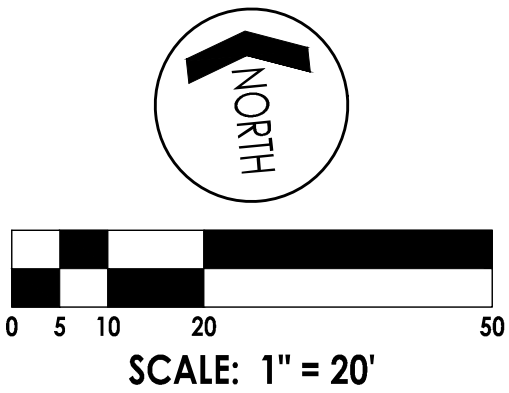

la terra studio[™]
landscape architecture
urban design planning
12001 north central expressway, suite 1170
dallas, texas ~ 75243 214.749.0333
www.laterrastudio.com



TBPE FIRM # 2448 | TBAE FIRM # BR 2261 | TBPELS FIRM # 10194493

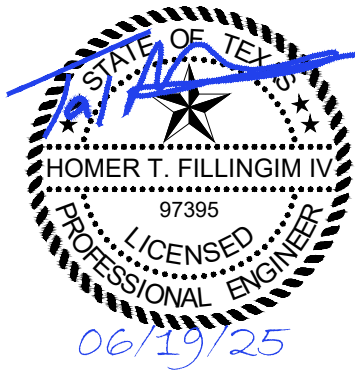

NO. Date Issues/Revisions

5/30/2025 ISSUE FOR BID

2 6/19/2025 ADDENDUM #4

STAMP

NOT FOR
CONSTRUCTION-
FOR PRICING ONLY

PROJECT NAME

CYPRESS STREET
PEDESTRIAN PARK
ABILENE,
TEXAS

CONSTRUCTION DOCUMENTATION

PROJECT NO.: 24507

DRAWN BY:

CHECKED BY:

DRAWING TITLE

GRADING
PLAN

DATE: MAY 30, 2025

SCALE: REFER TO PLANS

DRAWING NUMBER

C2.0

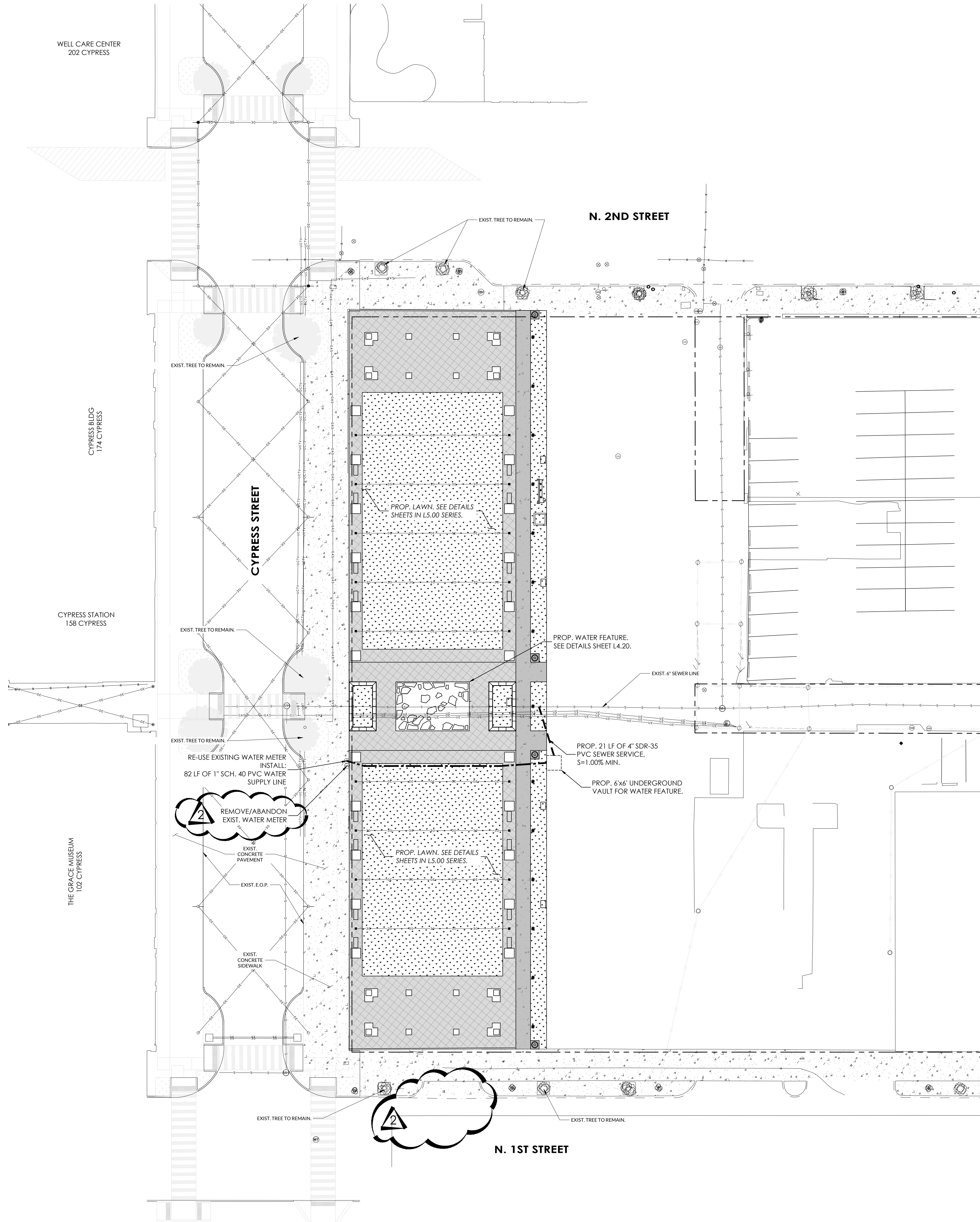

UTILITY GENERAL NOTES:

1. ALL MATERIALS AND CONSTRUCTION PROCEDURES WITHIN THE SCOPE OF THIS PROJECT SHALL CONFORM TO ALL APPLICABLE CITY OF ABILENE STANDARD SPECIFICATIONS FOR PUBLIC WORKS CONSTRUCTION, CITY BUILDING CODE AND REGULATIONS AS WELL AS OTHER SAFETY CODES AND INSPECTION PROVISIONS APPLICABLE TO THE PROJECT AND REQUIREMENTS OF THE FIRE DEPARTMENT.
2. THE CONTRACTOR SHALL BE RESPONSIBLE FOR ACQUIRING ALL PERMITS, TEST APPROVALS AND ACCEPTANCES REQUIRED TO COMPLETE CONSTRUCTION OF THIS PROJECT.
3. ALL WASTEWATER AND WATER SERVICE LINE INSTALLED INSIDE THE PROPERTY BOUNDARY SHALL BE PERFORMED BY A STATE OF TEXAS LICENSED PLUMBER.
4. THE CONTRACTOR SHALL FURNISH AND MAINTAIN ALL TRAFFIC CONTROL DEVICES, LIGHTING OR WARNING CONTROL DEVICES USED OR REQUIRED TO COMPLETE THE WORK.
5. CONTRACTOR SHALL BE RESPONSIBLE FOR RESTORING TO ORIGINAL CONDITION, OR BETTER, ANY DAMAGES DONE TO EXISTING BUILDINGS, RETAINING WALLS, UTILITIES, FENCES, PAVEMENT, CURBS OR DRIVEWAYS.
6. CONTRACTOR SHALL IMMEDIATELY NOTIFY THE ENGINEER OF ANY QUESTIONS THAT MAY ARISE CONCERNING THE INTENT, PLACEMENT, OR LIMITS, OF DIMENSIONS OR GRADES NECESSARY FOR CONSTRUCTION OF THIS PROJECT.
7. PROPOSED WATER & SEWER LINES SHALL BE INSTALLED A MINIMUM 30" BELOW PROPOSED FINISHED GROUND UNLESS OTHERWISE NOTED.
8. WATER & SEWER DETAILS INCLUDING TRENCHING, BLOCKING AND BACKFILLING REQUIREMENTS CAN BE FOUND ON DETAIL SHEET C-5.0.
9. WATER MAINS SHALL BE LOCATED UNDER THE GROUND SURFACE. CONTRACTOR SHALL PLACE A 2" WIDE METALIZED PLASTIC TAPE WITH THE WORD "WATER" (FACING UP) PRINTED ON THE TAPE TWO FEET ABOVE THE TOP OF THE PIPE.
10. WATER MAINS SHALL BE INSTALLED WITH A (STRANDED #12 AWG THWN OR THHN GAS AND OIL RESISTANT) TRACER WIRE AFFIXED TO THE TOP OF THE PIPE AND THE WIRE EXTENDED UP AND THROUGH ALL VALVE BOXES. THE CONTRACTOR IS RESPONSIBLE FOR MAKING SURE THE WIRES ARE ACCESSIBLE AT GATE VALVE BOXES.
11. ALL GATE VALVES SHALL HAVE AN 18"x18"x6" THICK 3000 PSI CONCRETE PAD, REINFORCED WITH 4-#3 REBAR, SURROUNDING THE TOP OF THE VALVE BOX.
12. METER BOXES SHALL BE PLACED ON A MINIMUM OF 9" OF CRUSHED GRANULAR MATERIAL (BUCKSHOT) FOR LEVELING AND TO PREVENT SETTLEMENT OF THE METER BOX.
13. THE CONTRACTOR SHALL PROVIDE WATER METER BOXES FOR EACH WATER SERVICE CONNECTION DETAILED ON THE PLANS. FOR WATER METER SIZES 1 1/2" TO 2", THE CONTRACTOR SHALL SUPPLY A BASS AND HAYS 1527 (AM COMPATIBLE) WATER METER BOX LD AND PWSBCF 1527-12 WATER METER BOX, OR EQUIVALENT. FOR WATER METER SIZES 5/8" TO 1", THE CONTRACTOR SHALL SUPPLY A BASS AND HAYS BH 1324 AMR LD WATER METER BOX LD AND PWSBCF 1324-12 WATER METER BOX, OR AN EAST JORDAN IRON WORKS PRODUCT NUMBER 32131365 (AM COMPATIBLE) 1324 WATER METER BOX LD AND PRODUCT NUMBER 32414001W WATER METER BOX, OR EQUIVALENT.
14. WATER VALVE BOXES SHALL BE SET IN 18"x18"x6" THICK REINFORCED CONCRETE APRON (3,000 PSI WITH NO. 3 BARS @ 12" O.C.E.W.)
15. TRACER WIRE AND METAL DETECTABLE TAPE SHALL BE INSTALLED WITH WATER AND SEWER MAINS PER CITY SPECIFICATIONS.

EXISTING UTILITY NOTES:

1. THIS UTILITY PLAN HAS BEEN PREPARED TO THE BEST OF OUR ABILITY USING THE DATA AVAILABLE. EXISTING UTILITY DATA SHOWN ON THIS LAYOUT WAS OBTAINED FROM A SURVEY OF THE VISIBLE FEATURES AT THE SITE AND INFORMATION OBTAINED FROM UTILITY COMPANIES.
2. THE CONTRACTOR WILL BE REQUIRED TO LOCATE ALL PUBLIC OR PRIVATE UTILITIES INCLUDING BUT NOT LIMITED TO: WATER, SEWER, TELEPHONE & FIBER OPTIC LINES, SITE LIGHTING, ELECTRIC, SECONDARY ELECTRIC, PRIMARY ELECTRIC DUCT BANKS, LANDSCAPE IRRIGATION FACILITIES AND GAS LINES. ANY UTILITY CONFLICTS THAT ARISE SHOULD BE COMMUNICATED TO THE ENGINEER IMMEDIATELY AND PRIOR TO CONSTRUCTION. THE CONTRACTOR SHALL CONTACT 1-800-DIG-TESS AND THE CITY OF ABILENE UTILITY LOCATE OFFICE AT (325) 676-6425 A MINIMUM OF 48 HOURS PRIOR TO THE START OF CONSTRUCTION. ANY DAMAGE TO EXISTING UTILITIES SHALL BE REPAIRED AT THE CONTRACTOR'S SOLE EXPENSE WHETHER THE UTILITY IS SHOWN ON THESE PLANS OR NOT.
3. THE CONTRACTOR NEEDS TO ALLOW FOR THE POSSIBILITY OF UNDETECTED UNDERGROUND UTILITIES WHETHER SHOWN ON THE PLANS OR NOT. ALSO THE CONTRACTOR MUST ALLOW FOR CHANGES DUE TO UTILITIES BEING IN LOCATIONS DIFFERENT FROM THOSE SHOWN ON THE UTILITY RECORD DRAWINGS. THE CONTRACTOR IS RESPONSIBLE FOR LOCATING AND EXPOSING CONFLICTS PRIOR TO CONSTRUCTION.









TRENCH EXCAVATION SAFETY PROTECTION:

CONTRACTOR AND/OR CONTRACTOR'S INDEPENDENTLY RETAINED EMPLOYEE OR STRUCTURAL DESIGN/GEOTECHNICAL SAFETY/EQUIPMENT CONSULTANT, IF ANY, SHALL REVIEW THESE PLANS AND ANY AVAILABLE GEOTECHNICAL INFORMATION AND THE ANTICIPATED INSTALLATION SITES WITHIN THE PROJECT WORK AREA IN ORDER TO IMPLEMENT THE CONTRACTOR'S TRENCH EXCAVATION SAFETY PROTECTION SYSTEMS, PROGRAMS AND/OR PROCEDURES FOR THE PROJECT DESCRIBED IN THE CONTRACT DOCUMENTS. THE CONTRACTOR'S IMPLEMENTATION OF THESE SYSTEMS, PROGRAMS AND/OR PROCEDURES SHALL PROVIDE FOR ADEQUATE TRENCH EXCAVATION SAFETY PROTECTION THAT COMPLIES WITH, AT A MINIMUM, OSHA STANDARDS FOR TRENCH EXCAVATIONS SPECIFICALLY. THE CONTRACTOR AND/OR CONTRACTOR'S INDEPENDENTLY RETAINED EMPLOYEE OR SAFETY CONSULTANT SHALL IMPLEMENT A TRENCH SAFETY PROGRAM IN ACCORDANCE WITH OSHA STANDARDS GOVERNING THE PRESENCE AND ACTIVITIES OF INDIVIDUALS WORKING IN AND AROUND TRENCH EXCAVATION.

FOUNTAIN SYSTEM NOTES

FOUNTAIN SYSTEM TO INCLUDE THE FOLLOWING:

1. RE-CIRCULATING PUMPS WITH PUMP CONTROLS LOCATED AT CENTRAL UNDERGROUND VAULT.
2. CENTRAL UNDERGROUND VAULT TO HOUSE WATER FOR FEATURE. VAULT TO INCLUDE BILCO HATCH FOR ACCESS, OVERFLOW TO SANITARY, AND EXHAUST FANS. ALL PIPES TO VAULT TO BE INSULATED.
3. REMOVABLE DEBRIS FILTER BASKET.
4. DEDICATED WATER SUPPLY AND METER.
5. CHECK VALVES.
6. BACK FLOW PREVENTER.
7. ADJUSTABLE FLOW VALVES.
8. ISOLATION VALVES.
9. BAFFLES.
10. INSULATED PIPES.
11. HEATER FOR PUMPS AND WATER FOR WINTER USE.
12. WATER STOPS AT ALL HARD CONNECTIONS. ENTIRE FEATURE TO BE WATERPROOFED, DAMP PROOF ALL STONE. ALL GROUT AND CAULK TO BE WATERPROOF AND FROST PROOF.
13. MECHANICAL ELECTRICAL AND PLUMBING TO BE DESIGNED AND DOCUMENTED (DESIGN BUILD) BY FOUNTAIN CONSULTANT/CONTRACTOR.
14. FOUNTAIN TO HAVE ALL NECESSARY ELECTRICAL AND PLUMBING CONNECTIONS AND RUNS. COORDINATED WITH PROJECT MEP.
15. LIGHTING TO BE PROVIDED BY CONTRACTOR AND COORDINATED WITH PROJECT ELECTRICAL ENGINEER. FOUNTAIN LIGHTING WILL CONSIST OF POOL BASIN LIGHTING AND LED STRIP LIGHTING.

UTILITY LEGEND			
	SITE BOUNDARY		PROPOSED STRING LIGHTS
	ADJACENT BOUNDARIES		EXISTING OVERHEAD POWER LINES
	UTILITY & DRAINAGE EASEMENTS		EXISTING UTILITY POLES
	PROPOSED WATER LINES		EXISTING STREET LIGHTS
	EXISTING WATER LINES		EXISTING GAS LINES
	PROPOSED SEWER SERVICE		EXIST. UNDERGROUND FIBER OPTIC
	EXISTING SANITARY SEWER MANHOLE		EXISTING FENCE
	EXISTING SEWER LINES		



PEDESTRIAN PLAZA
ABILENE, TEXAS

NO.	Date	Issues/Revisions
1	05/30/2025	ISSUE FOR BID
	06/19/2025	ADDENDUM #4

ISSUE
CONSTRUCTION DOCUMENTS

PROJECT NAME
PEDESTRIAN PLAZA
ABILENE, TEXAS

CONSTRUCTION DOCUMENTS

PROJECT NO.: 24010
DRAWN BY: GH, AR
CHECKED BY: HD, MB

DRAWING TITLE
OVERALL SITE PLAN

DATE: MAY 30, 2025
SCALE: REFER TO PLANS

DRAWING NUMBER

L0.10

DEMOLITION NOTE: REFER TO CIVIL
ENGINEER FOR ANY DEMOLITION NOT
NOTED HERE

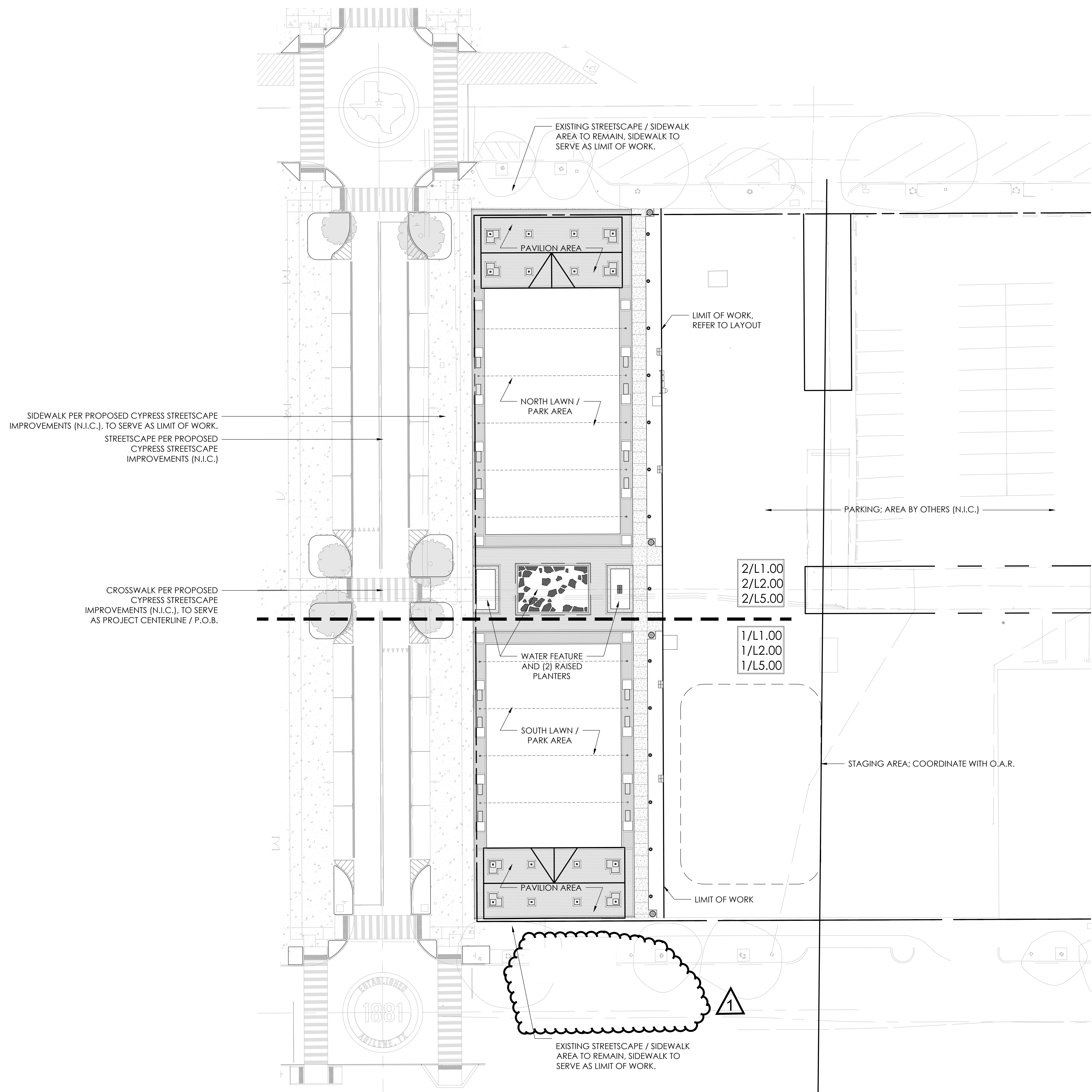

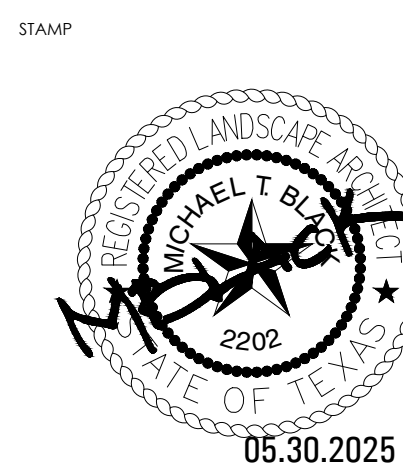

PEDESTRIAN PLAZA ABILENE, TEXAS

NO.	Date	Issues/Revisions
1	05/30/2025	ISSUE FOR BID
1	06/19/2025	ADDENDUM #4

CONSTRUCTION DOCUMENTS

PEDESTRIAN PLAZA

ABILENE,
TEXAS

CONSTRUCTION DOCUMENTS

PROJECT NO.: 24010
DRAWN BY: GH, AR
CHECKED BY: HD, MB

DRAWING NUMBER

SITE PLAN

DATE: MAY 30, 2025
SCALE: REFER TO PLANS

DRAWING NUMBER

L1.00

