

**ADDENDUM NO. 2
JANUARY 8, 2025**

**PROJECT: CITY OF RISING STAR
TWDB WATER LINE REPLACEMENT**

BID DATE: JANUARY 15, 2025

The following changes and/or additions shall be made to the Plans, Specifications, and Contract Documents for the above referenced project. Bidder shall acknowledge receipt of this Addendum by signing below and returning this Addendum with the Bid.

1) GENERAL

- a) The wage rates shall be replaced with the attached 2025 wage rates.
- b) The bid schedule shall be replaced with the attached copy.

2) PLAN SHEETS

- a) Sheet 3 shall be replaced with the attached copy. Slick bore has been added to cross the storm drain structure near STA 12+50.

Prepared by:

**JACOB | MARTIN
TBPE Firm No. 2448**

Bidder's Acknowledgment

Date



01/08/2025

"General Decision Number: TX20250087 01/03/2025

Superseded General Decision Number: TX20240087

State: Texas

Construction Type: Heavy

Counties: Blanco, Brown, Burnet, Coke, Coleman, Comanche, Concho, Eastland, Fisher, Gillespie, Kerr, Kimble, Llano, Mason, Mills, Mitchell, Nolan, Real, Runnels, San Saba, Schleicher, Shackelford and Stephens Counties in Texas.

HEAVY CONSTRUCTION PROJECTS

Note: Contracts subject to the Davis-Bacon Act are generally required to pay at least the applicable minimum wage rate required under Executive Order 14026 or Executive Order 13658. Please note that these Executive Orders apply to covered contracts entered into by the federal government that are subject to the Davis-Bacon Act itself, but do not apply to contracts subject only to the Davis-Bacon Related Acts, including those set forth at 29 CFR 5.1(a)(1).

<p>If the contract is entered into on or after January 30, 2022, or the contract is renewed or extended (e.g., an option is exercised) on or after January 30, 2022:</p>	<ul style="list-style-type: none"> . Executive Order 14026 generally applies to the contract. . The contractor must pay all covered workers at least \$17.75 per hour (or the applicable wage rate listed on this wage determination, if it is higher) for all hours spent performing on the contract in 2025.
<p>If the contract was awarded on or between January 1, 2015 and January 29, 2022, and the contract is not renewed or extended on or after January 30, 2022:</p>	<ul style="list-style-type: none"> . Executive Order 13658 generally applies to the contract. . The contractor must pay all covered workers at least \$13.30 per hour (or the applicable wage rate listed on this wage determination, if it is higher) for all hours spent performing on that contract in 2025.

The applicable Executive Order minimum wage rate will be adjusted annually. If this contract is covered by one of the Executive Orders and a classification considered necessary for performance of work on the contract does not appear on this wage determination, the contractor must still submit a conformance request.

Additional information on contractor requirements and worker protections under the Executive Orders is available at <http://www.dol.gov/whd/govcontracts>.

type(s) of construction and geographic area covered by the wage determination. The classifications are listed in alphabetical order under rate identifiers indicating whether the particular rate is a union rate (current union negotiated rate), a survey rate, a weighted union average rate, a state adopted rate, or a supplemental classification rate.

Union Rate Identifiers

A four-letter identifier beginning with characters other than ""SU"", ""UAVG"", ?SA?, or ?SC? denotes that a union rate was prevailing for that classification in the survey. Example: PLUM0198-005 07/01/2024. PLUM is an identifier of the union whose collectively bargained rate prevailed in the survey for this classification, which in this example would be Plumbers. 0198 indicates the local union number or district council number where applicable, i.e., Plumbers Local 0198. The next number, 005 in the example, is an internal number used in processing the wage determination. The date, 07/01/2024 in the example, is the effective date of the most current negotiated rate.

Union prevailing wage rates are updated to reflect all changes over time that are reported to WHD in the rates in the collective bargaining agreement (CBA) governing the classification.

Union Average Rate Identifiers

The UAVG identifier indicates that no single rate prevailed for those classifications, but that 100% of the data reported for the classifications reflected union rates. EXAMPLE: UAVG-OH-0010 01/01/2024. UAVG indicates that the rate is a weighted union average rate. OH indicates the State of Ohio. The next number, 0010 in the example, is an internal number used in producing the wage determination. The date, 01/01/2024 in the example, indicates the date the wage determination was updated to reflect the most current union average rate.

A UAVG rate will be updated once a year, usually in January, to reflect a weighted average of the current rates in the collective bargaining agreements on which the rate is based.

Survey Rate Identifiers

The ""SU"" identifier indicates that either a single non-union rate prevailed (as defined in 29 CFR 1.2) for this classification in the survey or that the rate was derived by computing a weighted average rate based on all the rates reported in the survey for that classification. As a weighted average rate includes all rates reported in the survey, it may include both union and non-union rates. Example: SUFL2022-007 6/27/2024. SU indicates the rate is a single non-union prevailing rate or a weighted average of survey data for that classification. FL indicates the State of Florida. 2022 is the year of the survey on which these classifications and rates are based. The next number, 007 in the example, is an internal number used in producing the wage determination. The date, 6/27/2024 in the example, indicates the survey completion date for the classifications and rates under that identifier.

?SU? wage rates typically remain in effect until a new survey is conducted. However, the Wage and Hour Division (WHD) has the discretion to update such rates under 29 CFR 1.6(c)(1).

State Adopted Rate Identifiers

The ""SA"" identifier indicates that the classifications and prevailing wage rates set by a state (or local) government were adopted under 29 C.F.R 1.3(g)-(h). Example: SAME2023-007 01/03/2024. SA reflects that the rates are state adopted. ME refers to the State of Maine. 2023 is the year during which the state completed the survey on which the listed classifications and rates are based. The next number, 007 in the example, is an internal number used in producing the wage determination. The date, 01/03/2024 in the example, reflects the date on which the classifications and rates under the ?SA? identifier took effect under state law in the state from which the rates were adopted.

WAGE DETERMINATION APPEALS PROCESS

1) Has there been an initial decision in the matter? This can be:

- a) a survey underlying a wage determination
- b) an existing published wage determination
- c) an initial WHD letter setting forth a position on a wage determination matter
- d) an initial conformance (additional classification and rate) determination

On survey related matters, initial contact, including requests for summaries of surveys, should be directed to the WHD Branch of Wage Surveys. Requests can be submitted via email to davisbaconinfo@dol.gov or by mail to:

Branch of Wage Surveys
Wage and Hour Division
U.S. Department of Labor
200 Constitution Avenue, N.W.
Washington, DC 20210

Regarding any other wage determination matter such as conformance decisions, requests for initial decisions should be directed to the WHD Branch of Construction Wage Determinations. Requests can be submitted via email to BCWD-Office@dol.gov or by mail to:

Branch of Construction Wage Determinations
Wage and Hour Division
U.S. Department of Labor
200 Constitution Avenue, N.W.
Washington, DC 20210

2) If an initial decision has been issued, then any interested party (those affected by the action) that disagrees with the decision can request review and reconsideration from the Wage and Hour Administrator (See 29 CFR Part 1.8 and 29 CFR Part 7). Requests for review and reconsideration can be submitted via email to dba.reconsideration@dol.gov or by mail to:

Wage and Hour Administrator
U.S. Department of Labor
200 Constitution Avenue, N.W.
Washington, DC 20210

The request should be accompanied by a full statement of the

interested party's position and any information (wage payment data, project description, area practice material, etc.) that the requestor considers relevant to the issue.

3) If the decision of the Administrator is not favorable, an interested party may appeal directly to the Administrative Review Board (formerly the Wage Appeals Board). Write to:

Administrative Review Board
U.S. Department of Labor
200 Constitution Avenue, N.W.
Washington, DC 20210.

=====

END OF GENERAL DECISION"

**CITY OF RISING STAR
 TWDB WATER LINE REPLACEMENT
 BASE BID A SCHEDULE
 ADDENDUM #2 MODIFIED**

Show prices in numerals. Round off unit prices to two decimal places only.

These Bid Prices must include all labor, materials, equipment, insurance, overhead, superintendence, transportation, profits & incidentals to cover the finished Work called for in the Contract Documents.

For all Labor, Materials, Equipment and Incidentals to Furnish and Install the Following:

Bid Item	Description	Est. Qty.	Unit	Unit Price	Extended Amount
1	Mobilization, Bonds, & Insurance	1	LS	\$	\$
2	6" DR-25 C900 PVC Water Line	800	LF	\$	\$
3	6" Gate Valve & Box	5	EA	\$	\$
4	4" Gate Valve & Box	1	EA	\$	\$
5	6" Water Line Connection	1	EA	\$	\$
6	4" Water Line Connection w/ 4" Tapping Sleeve	1	EA	\$	\$
7	Cut & Plug Water Line	1	EA	\$	\$
8	Remove Existing Fire Hydrant	2	EA	\$	\$
9	6" Fire Hydrant	2	EA	\$	\$
10	Short Service Reconnect	1	EA	\$	\$
11	Base Repair	50	LF	\$	\$
12	6" Slick Bore	50	LF	\$	\$
TOTAL BASE BID A (Items 1-12)					\$

NOTES:

IT IS NOT EXPECTED THAT ANY EXCAVATION GREATER THAN A 5 FOOT DEPTH WILL BE REQUIRED; HOWEVER, TRENCH SAFETY BID ITEM IS INCLUDED IN THE EVENT THAT THIS TYPE OF EXCAVATION OCCURS DURING CONSTRUCTION.

TRENCH SAFETY (\$/LF)

OWNER MAY AWARD FINAL CONTRACT FOR ANY INDIVIDUAL OR COMBINATION OF BASE BIDS (A, B, C, OR D) AS BUDGET ALLOWS.

**CITY OF RISING STAR
 TWDB WATER LINE REPLACEMENT
 BASE BID A, ALTERNATE BID #1 SCHEDULE
 ADDENDUM #2 MODIFIED**

Show prices in numerals. Round off unit prices to two decimal places only.

These Bid Prices must include all labor, materials, equipment, insurance, overhead, superintendence, transportation, profits & incidentals to cover the finished Work called for in the Contract Documents.

ADDITIVE ALTERNATE BID SCHEDULE

For all Labor, Materials, Equipment and Incidentals to Furnish and Install the Following:

Bid Item	Description	Est. Qty.	Unit	Unit Price	Extended Amount
1	Mobilization, Bonds, & Insurance	1	LS	\$	\$
2	6" DR-25 C900 PVC Water Line	1,000	LF	\$	\$
3	6" Gate Valve & Box	4	EA	\$	\$
4	6" Water Line Connection w/ 6" Tapping Sleeve	1	EA	\$	\$
5	Cut & Plug Water Line	1	EA	\$	\$
6	Remove Existing Fire Hydrant	1	EA	\$	\$
7	6" Fire Hydrant	3	EA	\$	\$
8	Short Service Reconnect	4	EA	\$	\$
9	Base Repair	60	LF	\$	\$
10	6" Slick Bore	190	LF	\$	\$
	TOTAL BASE BID A, ADDITIVE ALTERNATE BID #1 (Items 1-10)				\$

**CITY OF RISING STAR
 TWDB WATER LINE REPLACEMENT
 BASE BID B SCHEDULE
 ADDENDUM #2 MODIFIED**

Show prices in numerals. Round off unit prices to two decimal places only.

These Bid Prices must include all labor, materials, equipment, insurance, overhead, superintendence, transportation, profits & incidentals to cover the finished Work called for in the Contract Documents.

For all Labor, Materials, Equipment and Incidentals to Furnish and Install the Following:

Bid Item	Description	Est. Qty.	Unit	Unit Price	Extended Amount
1	Mobilization, Bonds, & Insurance	1	LS	\$	\$
2	8" DR-25 C900 PVC Water Line	40	LF	\$	\$
3	6" DR-25 C900 PVC Water Line	1,068	LF	\$	\$
4	4" DR-25 C900 PVC Water Line	40	LF	\$	\$
5	6" Gate Valve & Box	11	EA	\$	\$
6	4" Gate Valve & Box	1	EA	\$	\$
7	8" Water Line Connection	1	EA	\$	\$
8	6" Water Line Connection w/ 6" Tapping Sleeve	2	EA	\$	\$
9	4" Water Line Connection	1	EA	\$	\$
10	Cut & Plug Water Line	2	EA	\$	\$
11	Remove Existing Fire Hydrant	1	EA	\$	\$
12	6" Fire Hydrant	3	EA	\$	\$
13	Long Service Reconnect	1	EA	\$	\$
14	Asphalt Repair	75	LF	\$	\$
15	Base Repair	20	LF	\$	\$
	TOTAL BASE BID B (Items 1-15)				\$

**CITY OF RISING STAR
 TWDB WATER LINE REPLACEMENT
 BASE BID C SCHEDULE
 ADDENDUM #2 MODIFIED**

Show prices in numerals. Round off unit prices to two decimal places only.

These Bid Prices must include all labor, materials, equipment, insurance, overhead, superintendence, transportation, profits & incidentals to cover the finished Work called for in the Contract Documents.

For all Labor, Materials, Equipment and Incidentals to Furnish and Install the Following:

Bid Item	Description	Est. Qty.	Unit	Unit Price	Extended Amount
1	Mobilization, Bonds, & Insurance	1	LS	\$	\$
2	6" DR-25 C900 PVC Water Line	1,343	LF	\$	\$
3	6" Gate Valve & Box	5	EA	\$	\$
4	4" Gate Valve & Box	1	EA	\$	\$
5	2" Gate Valve & Box	2	EA	\$	\$
6	6" Water Line Connection	1	EA	\$	\$
7	4" Water Line Connection w/ 4" Tapping Sleeve	1	EA	\$	\$
8	2" Water Line Connection	1	EA	\$	\$
9	Cut & Plug Water Line	1	EA	\$	\$
10	6" Fire Hydrant	2	EA	\$	\$
11	Short Service Reconnect	1	EA	\$	\$
12	Base Repair	210	LF	\$	\$
13	6" Slick Bore	65	LF	\$	\$
	TOTAL BASE BID C (Items 1-13)				\$

**CITY OF RISING STAR
 TWDB WATER LINE REPLACEMENT
 BASE BID D SCHEDULE
 ADDENDUM #2 MODIFIED**

Show prices in numerals. Round off unit prices to two decimal places only.

These Bid Prices must include all labor, materials, equipment, insurance, overhead, superintendence, transportation, profits & incidentals to cover the finished Work called for in the Contract Documents.

For all Labor, Materials, Equipment and Incidentals to Furnish and Install the Following:

Bid Item	Description	Est. Qty.	Unit	Unit Price	Extended Amount
1	Mobilization, Bonds, & Insurance	1	LS	\$	\$
2	6" DR-25 C900 PVC Water Line	947	LF	\$	\$
3	6" DR-18 C900 PVC Restrained Joint Water Line (Open Cut)	160	LF	\$	\$
4	6" Gate Valve & Box	14	EA	\$	\$
5	4" Gate Valve & Box	1	EA	\$	\$
6	2" Gate Valve & Box	2	EA	\$	\$
7	8" Water Line Connection w/ 8" Tapping Sleeve	1	EA	\$	\$
8	6" Water Line Connection w/ 6" Tapping Sleeve	1	EA	\$	\$
9	4" Water Line Connection	1	EA	\$	\$
10	2" Water Line Connection	2	EA	\$	\$
11	Cut & Plug Water Line	1	EA	\$	\$
12	Remove Existing Fire Hydrant	1	EA	\$	\$
13	6" Fire Hydrant	4	EA	\$	\$
14	Short Service Reconnect	1	EA	\$	\$
15	Long Service Reconnect	1	EA	\$	\$
16	Base Repair	475	LF	\$	\$
17	6" Slick Bore	20	LF	\$	\$
18	Directional Bore to Cross Creek	1	LS	\$	\$
	TOTAL BASE BID D (Items 1-18)				\$

Plot Date: 1/7/2025 3:32 PM

Plotted by: luke van diest

Save Time: 1/7/2025 3:16 PM

Saved By: Ivandiest

X:_L_Rising_Star\18552-Rising Star\TWPB VSS Application\Drafting\Plane\Civil\Sheet 3 PLAN.dwg

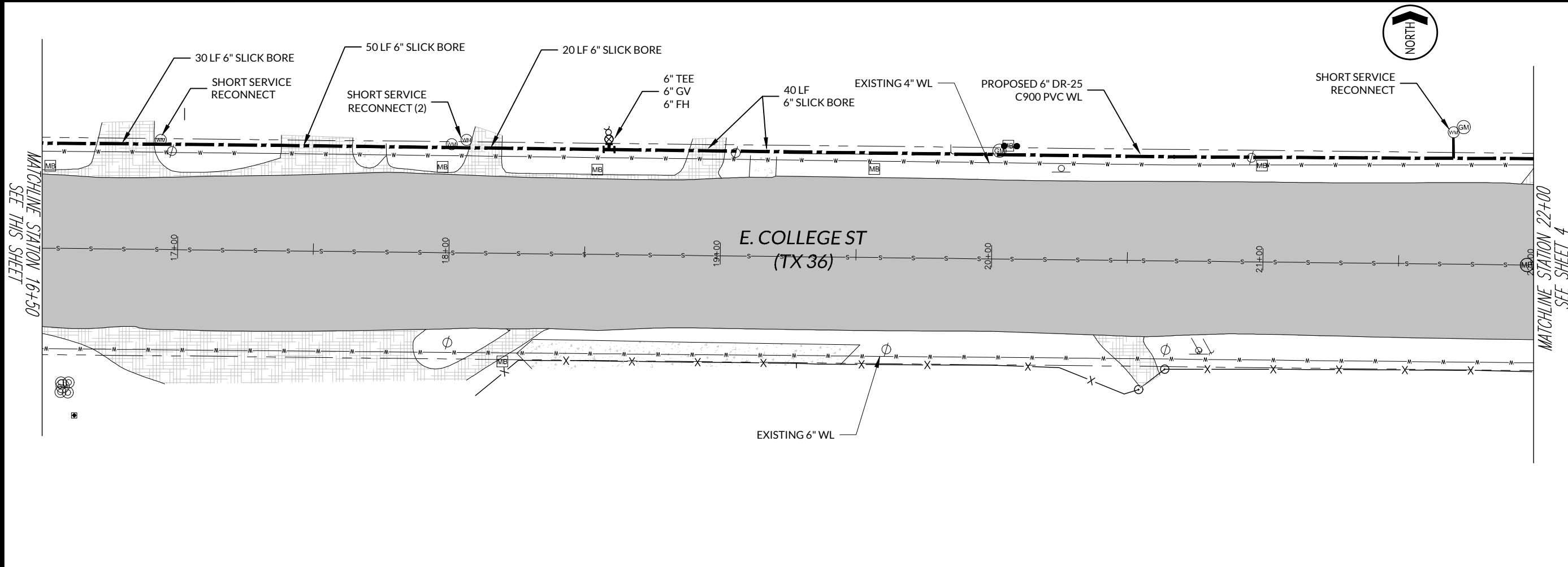
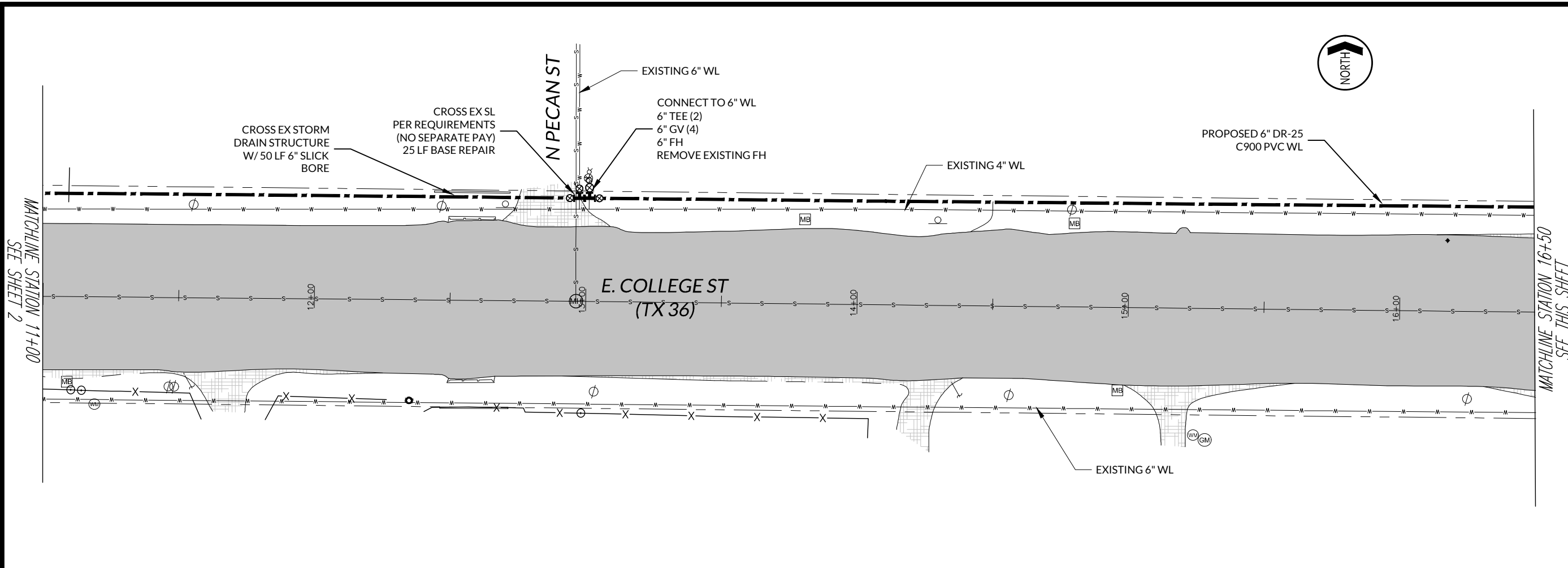

ISSUED FOR BID/PERMIT

JACOB MARTIN
 TBP&S FIRM # 10194493
 TBA&E FIRM # ER 2261
 TBP&E FIRM # 2448

CITY OF RISING STAR, TEXAS
TWDB WATERLINE REPLACEMENT
WATER LINE PLAN

NO.	REVISION	DATE

PROJECT # 18552
 SCALE 1" = 40'
 BASIS ONE INCH LENGTH ON ORIGINAL DRAWING.
 CHECK SCALE AND ADJUST ACCORDINGLY.

3	15	3
---	----	---